

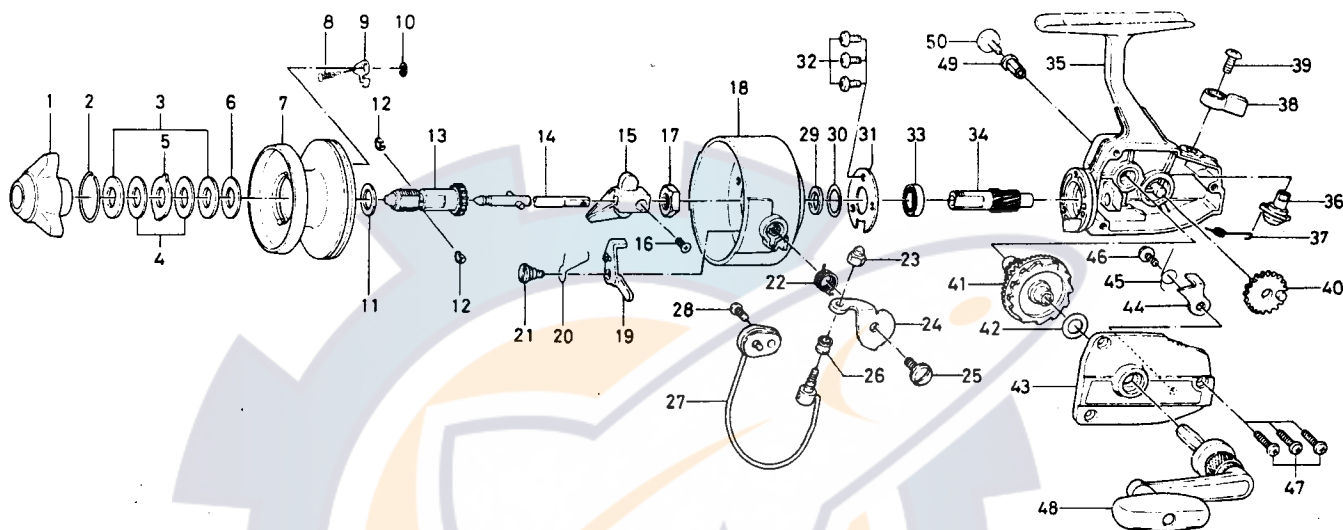

SPINNING REEL **8350HRL**



KEY NO. 1 ~ 13
6-733-7601

SPOOL ASSEMBLY

Key No.	Parts No.	Parts Name
1	6-740-4201	Drag knob
2	6-171-7701	Drag washer retainer
3	6-374-4802	Drag washer A
4	6-373-3701	Drag washer B
5	6-373-3603	Drag washer C
6	6-373-3704	Drag washer D
7	6-514-3401	Spool
8	6-145-2101	Spool click claw spring
9	6-807-5301	Spool click claw
10	6-320-5901	Spool click claw retainer
11	6-375-5701	Spool washer
12	6-151-7211	Spool metal leaf spring
13	6-720-1721	Spool metal
14	6-711-4501	Main shaft
15	6-481-1501	Oscillating slider
16	6-351-5311	Oscillating slider screw
17	6-340-6602	Rotor nut
18	6-202-1401	Rotor
19	6-571-0001	Bail kick lever
20	6-143-4801	Bail kick lever spring
21	6-361-8202	Bail kick lever screw
22	6-141-0651	Bail spring
23	6-341-2701	Bail nut
24	6-231-0431	Arm lever
25	6-361-8532	Arm lever screw

Key No.	Parts No.	Parts Name
26	6-250-1921	Line roller
27	6-725-8601	Bail
28	6-351-6401	Bail holder screw
29	6-373-7804	Pinion washer A
30	6-372-7600	Pinion washer B
31	6-633-5521	Ball bearing ret. washer
32	6-350-1931	Ball bearing ret. washer screw
33	6-631-6901	Ball bearing
34	6-403-2101	Pinion gear
35	6-701-3904	Body
36	6-460-6821	Anti-reverse cam
37	6-142-2801	Anti-reverse cam spring
38	6-541-3132	Anti-reverse lever
39	6-351-4701	Anti-reverse lever screw
40	6-413-4501	Oscillating gear
41	6-414-1201	Drive gear
42	6-370-5100	Drive gear washer
43	6-706-9604	Body cover
44	6-111-3411	Anti-reverse claw
45	6-143-9601	Anti-reverse claw spring
46	6-351-7701	Anti-reverse claw screw
47	6-351-6401	Body cover screw
48	6-746-1341	Handle
49	6-501-8501	Handle screw holder
50	6-822-3401	Handle screw